

Customer Name

Account #

PO#

Quote #

Location / Lot #

1 Lifetime Glass Protection
 Yes, add Diamon-Fusion (DFI) No, I like scrubbing

2 Hardware Finish
 Chrome / Silver Brushed Nickel Dark Anodized Powder Coated _____

3 Glass Color
 Clear Pattern 62 Aquatex Rain Low Iron (SFL only) Satin Etch (SFL only)

4 Door Type

* Denotes Standard Option

<input type="checkbox"/> Framed*	<input type="checkbox"/> Semi-Frameless Edge-Mount Handle*	<input type="checkbox"/> Hybrid Enclosure
<input type="checkbox"/> Framed w/ 6" C-Pull Handle	<input type="checkbox"/> Semi-Frameless 6" C-Pull Handle	1/4" semi-frameless door with 6" c-pull & 3/8" glass panels with channel.
<input type="checkbox"/> ADA Option - must be 36"W	<input type="checkbox"/> Panoramic with Middle Strike*	<input type="checkbox"/> No threshold under door*
<input type="checkbox"/> Half-Moon Base Option	<input type="checkbox"/> Panoramic with Header Strike	<input type="checkbox"/> Full threshold under door and panel
		<input type="checkbox"/> Use fabricated clamps
		<input type="checkbox"/> Use non-fabricated clips

Upgrade to Panoramic PLUS
Formerly known as "Mungo Layout"

 Semi-frameless w/ c-pull, panoramic center strike, aquarium corner, no threshold metal on notch rise, buttress, or return.

5 Top Options

* Denotes Standard Option

 Header* No Header (Standalone doors or panels only)

6 Curb/Base Options

* Denotes Standard Option

 Full Base* Half-Moon Dam No Threshold

7 Door Width

* Denotes Standard Option

 Stock Door (30" Width)* Stock Door (34" Width SFL w/C-Pull) Custom _____

8 Unit Height
 67" (Framed Only) 71" 76" 80" Custom _____

9 Panel Options

Check all that apply

* Denotes Standard Option

 Corner Post* Aquarium Corner (butt-glaze)
 Notched Panel Notched Panel - No metal on rise or base

Please provide centerline dimensions. Note any and all out-of-plumb walls & thresholds.

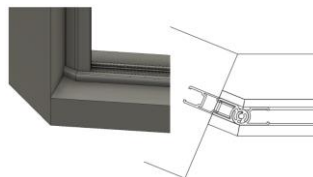
 Angled Kneewall conversion kit (specify angle in drawing)

Submit order here

