

Opening Height = 80

Opening Width = 40

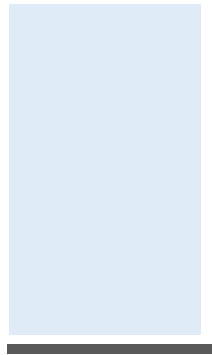

Deduction for channel on any edge is 5/16"

Actual glass width and height:

Width minus 5/16"
 $40 - 5/16 = 39 \frac{11}{16}$ "

Height minus 5/16"
 $80 - 5/16 = 79 \frac{11}{16}$ "

Overall Opening Width = 40

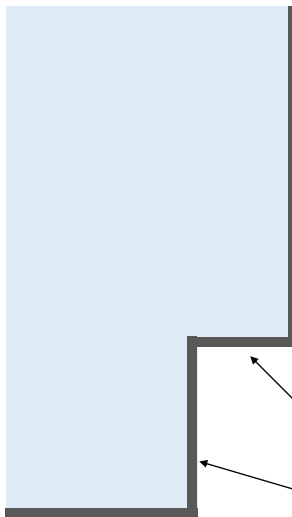

Opening Height = 80

Knee Opening Width = 10

Rise Height = 20

Base Opening Width = 30

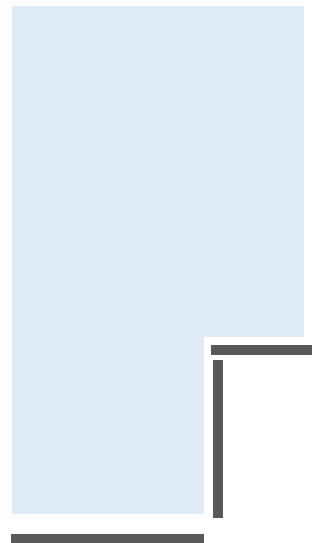

Deduction for channel on any edge is 5/16"

Actual glass widths and heights:

Base = Width minus 5/16"
 $30 - 5/16 = 29 \frac{11}{16}$ "

Rise = Rise Height **minus** 5/16" (bottom channel)
plus 5/16" (upward deduction from channel on kneewall)
 $20 - 5/16" + 5/16" = 20$

Kneewall = Width **plus** 5/16" (inward deduction from channel up rise) **minus** 5/16" (inward deduction from channel at wall)
 $10 + 5/16" - 5/16" = 10$

Top = Overall width minus 5/16" (wall channel)
 $40 - 5/16 = 39 \frac{11}{16}$ "

Double-check by adding deducted base and deducted kneewall:
 $29 \frac{11}{16} + 10 = 39 \frac{11}{16}$ "

Height minus 5/16"
 $80 - 5/16 = 79 \frac{11}{16}$ "

U-channel systems for panels allow flexibility. Depending on the actual glass size and opening size, under ideal conditions you can shrink or stretch 3/16" either way.

